

# DUETTE

DIAGRAM 1

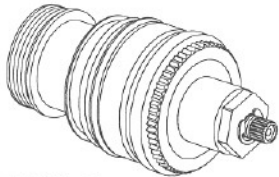

DIAGRAM 2

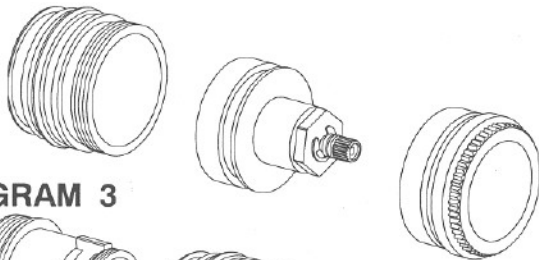

DIAGRAM 3

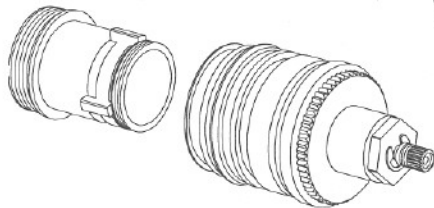

DIAGRAM 4

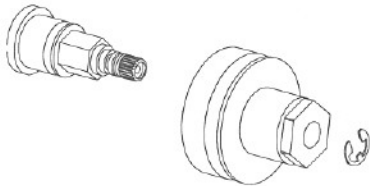

DIAGRAM 5



- TO DIS-ASSEMBLE CARTRIDGE
- REMOVE CARTRIDGE FROM BODY
- REMOVE CIRCLIP FROM SPINDLE AND PUSH SPINDLE OUT
- REMOVE SPINDLE FROM SPINDLE HOUSING (LEFT HAND THREAD) UNSCREW TEMPERATURE ADJUST SCREW FROM SPINDLE HOUSING
- THE DIVERTOR ASSEMBLY IS A TWO PART ASSEMBLY AND UNSCREWS THIS IS A MULTI START RIGHT HAND THREAD