

# TS1600, DIAMOND, TURQUOISE, OPAL

DIAGRAM 1

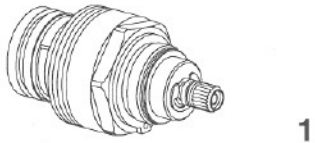

DIAGRAM 2

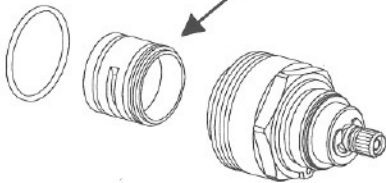

DIAGRAM 3

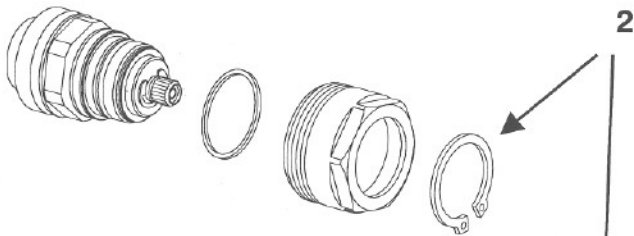

DIAGRAM 4

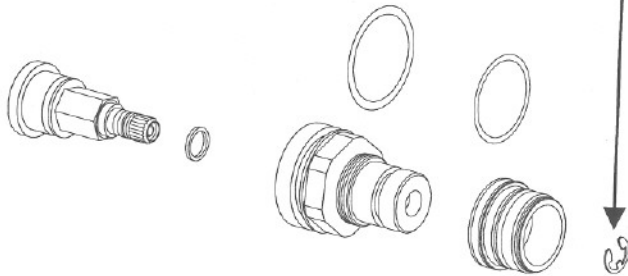
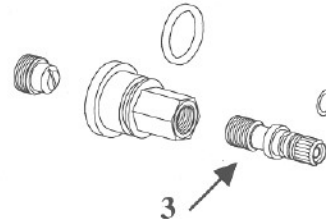

DIAGRAM 5



- TO DIS-ASSEMBLE CARTRIDGE
- REMOVE CARTRIDGE FROM BODY AS INDICATED IN DIAGRAM 1
- UNSCREW HALF CARTRIDGE (1) BY INSERTING A FLAT TOOL SUCH AS A FILE THROUGH THE THE HALF CARTRIDGE SLOTS AND A SPANNER OR VICE ON THE LARGE HEXAGON OF THE HEAD DRIVING ONE AGAINST THE OTHER (THE HALF CARTRIDGE IS A STANDARD RIGHT HAND THREAD) AS PER DIAGRAM 2
- REMOVE THE TWO CIRCLIPS (2) AND PUSH THE SPINDLE AND FLOW HEAD OUT OF THE HEAD AS PER DIAGRAM 3 & 4
- REMOVE SPINDLE (3) FROM SPINDLE HOUSING (AS PER DIAGRAM 5)