

# AQUA MARINE

DIAGRAM 1

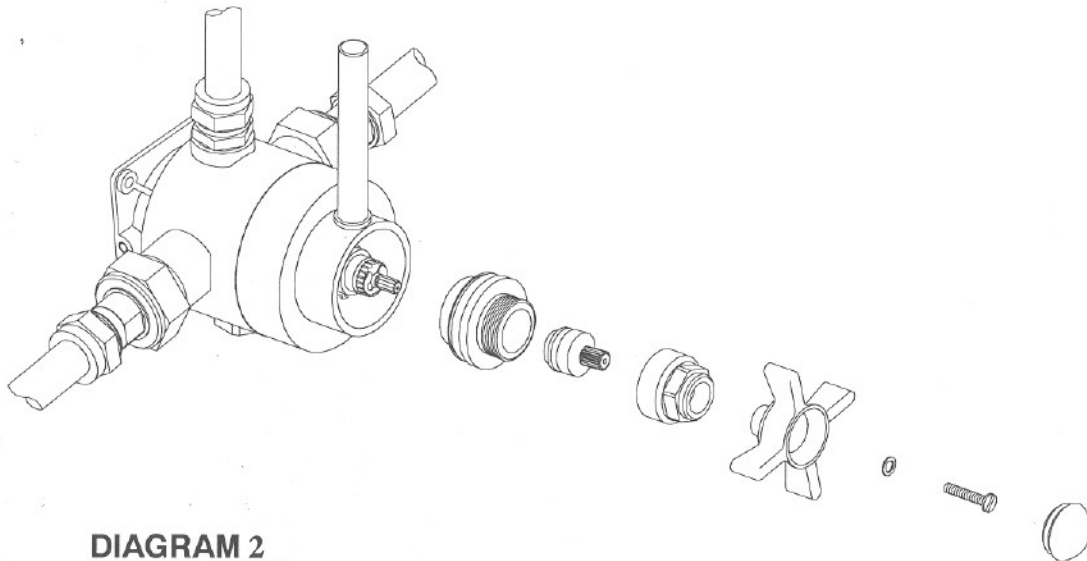

- REMOVAL OF CONTROL ASSEMBLY
- GENTLY PRISE OUT INDICE TO EXPOSE RETAINING SCREW
- REMOVE SCREW AND PULL OUT CONTROL KNOB
- UNSCREW HEAD SLEEVE AND PULL OUT SPINDLE EXTENTION
- PULL OUT SPACER
- REMOVE CIRCLIP (1) AND PULL OFF LEVER ASSEMBLY
- USING A 2.5 MM ALLEN KEY REMOVE GRUB SCREW
- PULL OFF BODY SLEEVE

DIAGRAM 2

